

Engrove Roller

Engraving roller can directly process mesh holes and concave convex patterns of various lines on the steel roller surface, it has a long service life and a uniform pattern, which is suitable for compound gluing, coating, ink transfer, polishing and other areas.

Carving roller is mainly used for sizing and coloring. Suitable for plastic, leather, paper, carton machinery and other industries.

Technical parameters:

- 1.The mesh number, pattern and specification are complete. Engraving roller can be selected from 10-600 lines / inch according to the user's requirements;
- 2.Static balance and e-level dynamic balance below 300 rpm shall be corrected;
3. 45 × seamless tube shall be selected, and the inner hole shall be processed, welded and tempered;
4. Coaxiality shall be $\leq 0.025\text{mm}$;
5. The surface shall be polished after chromium plating, and the hardness shall be above HRC62.

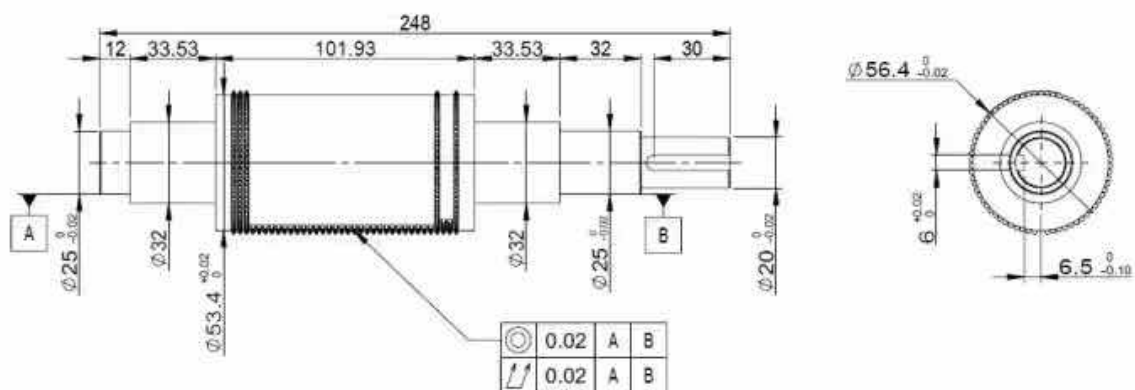

- 要求:
- 1.压辊齿型按3D图加工;
 - 2.加工工艺需符合口罩压辊加工方式;

Product link : <https://www.airshaft-china.com/?p=418451>